

ASSEMBLY LIST				
MARK	DESCRIPTION	PSC	LENGTH	WEIGHT

REFERENCES	
DEFAULT WELDING	UNLESS OTHERWISE NOTED
WELDING CLASS	
CLASS OF DRIP/CHIPPING	
SURFACE TREATMENT	
PAINTING	

FASTENING SCREWS
 CASETTI 200/1.2, 1.5 / COLUMN P200-R, SD12-T15-5.5x36 cc 300
 CASETTI 200/1.2, 1.5 / COLUMN HE300B TDB-T-116-6.5x38 cc 300
 CASETTI 200/1.2, 1.5 / CASETTI 200/1.2, 1.5 SL3-H15-6.5x32 cc 300

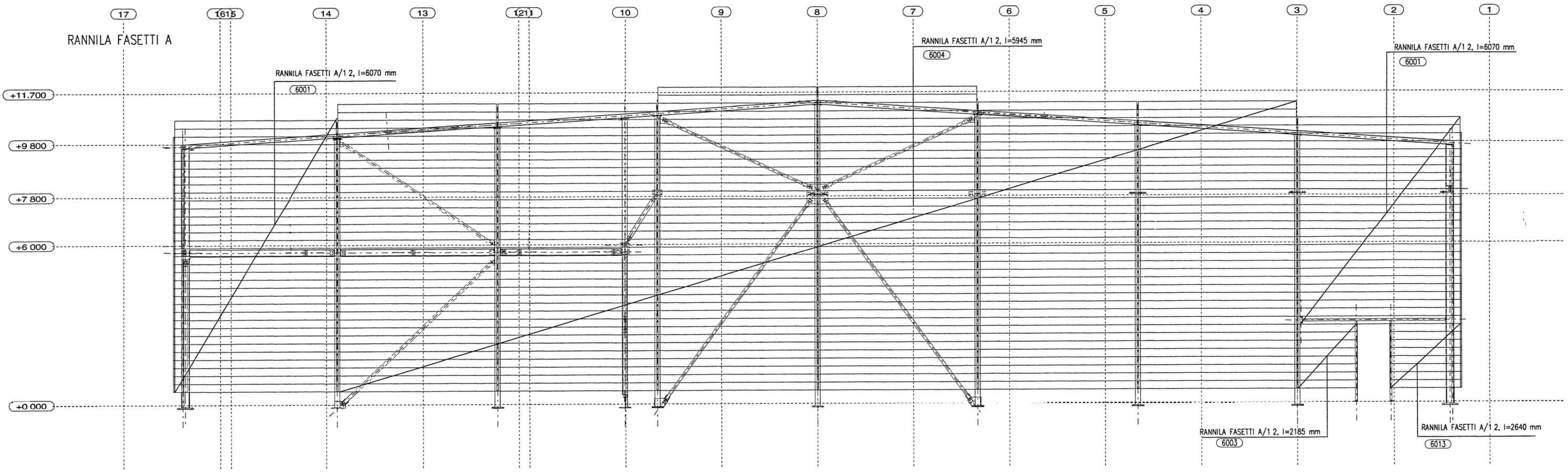

RANNILA CASETTI 200/1.2
 RANNILA CASETTI 200/1.5, PERFORATED

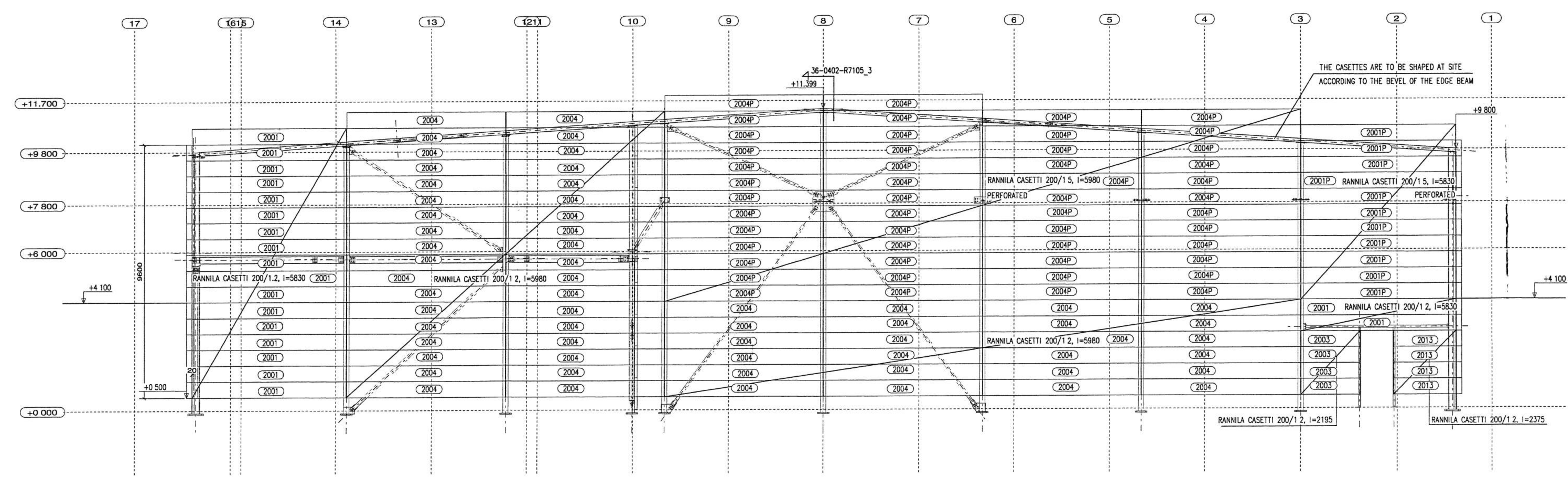

PURPOSE	PURPOSE			PURPOSE	
	A - FOR DESIGN	B - FOR INFORMATION	C - FOR CONSTRUCTION	D - FOR INFORMATION	E - FOR INFORMATION
1 - PRELIMINARY	2 - PRELIMINARY	3 - PRELIMINARY	4 - PRELIMINARY	5 - PRELIMINARY	6 - PRELIMINARY
7 - PRELIMINARY	8 - PRELIMINARY	9 - PRELIMINARY	10 - PRELIMINARY	11 - PRELIMINARY	12 - PRELIMINARY
13 - PRELIMINARY	14 - PRELIMINARY	15 - PRELIMINARY	16 - PRELIMINARY	17 - PRELIMINARY	18 - PRELIMINARY

DATE	NO	REVISION	REV BY	APPR
31.10.2000	B	RANNILA FASETTI ELEMENTS ADDED	AV	RR
19.10.2000	A	MODIFIED	AV	RR

AARO KOHONEN OY
 consulting engineers

Project name: Rannila Steel Oy
 Sport Hall / Iceland

Scale: 1/75
 Drawing no: R16-17-1.2

Client: Rannila Steel Oy
 Designer: RR
 Date: 27.09.2000

Project no: 36-0402 -7111 / B