

SAMÞYKKT AF BYGGINGARFULLTRÍA  
 15. OKT. 2019  
 BYGGINGARFULLTRÚNN Í VESTMANNNAEYUM

HÖNNUNARSTÍÐI

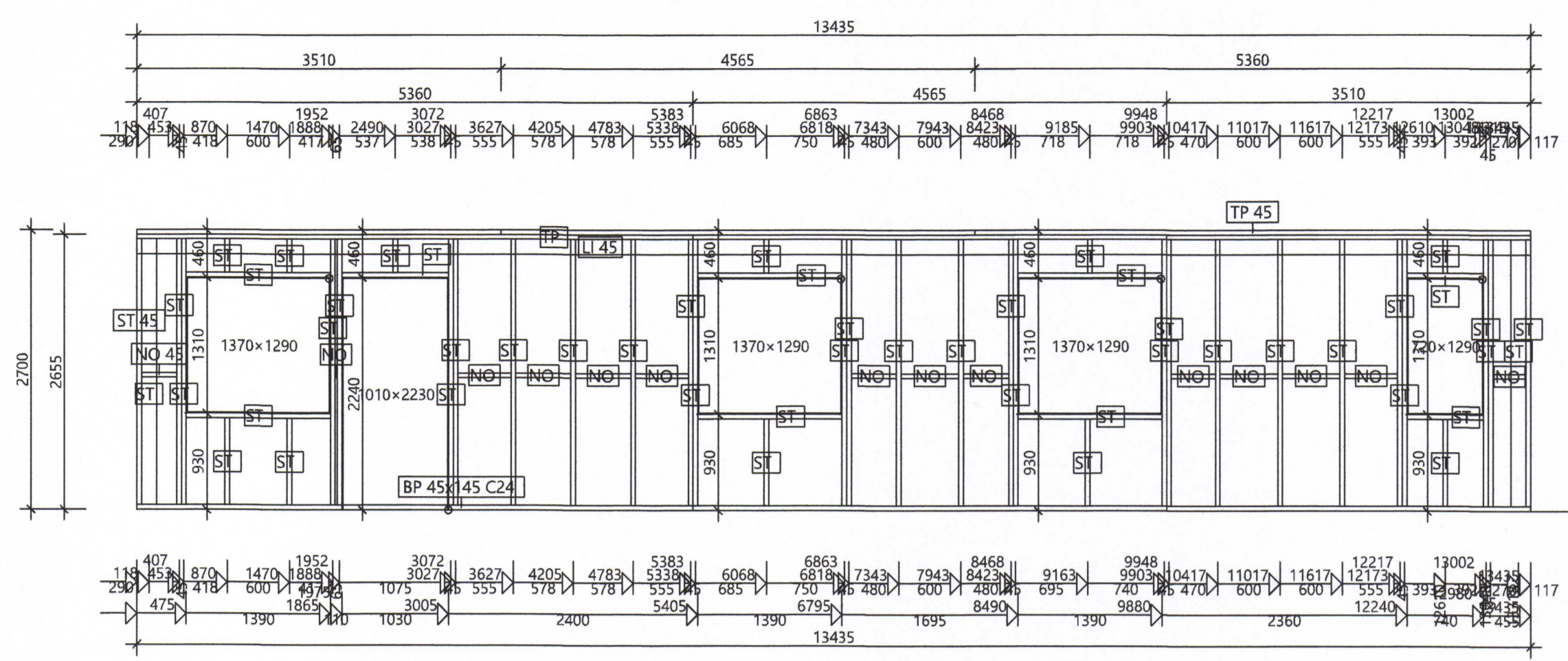

WP1 - 1 no. 1-ply 478 kg

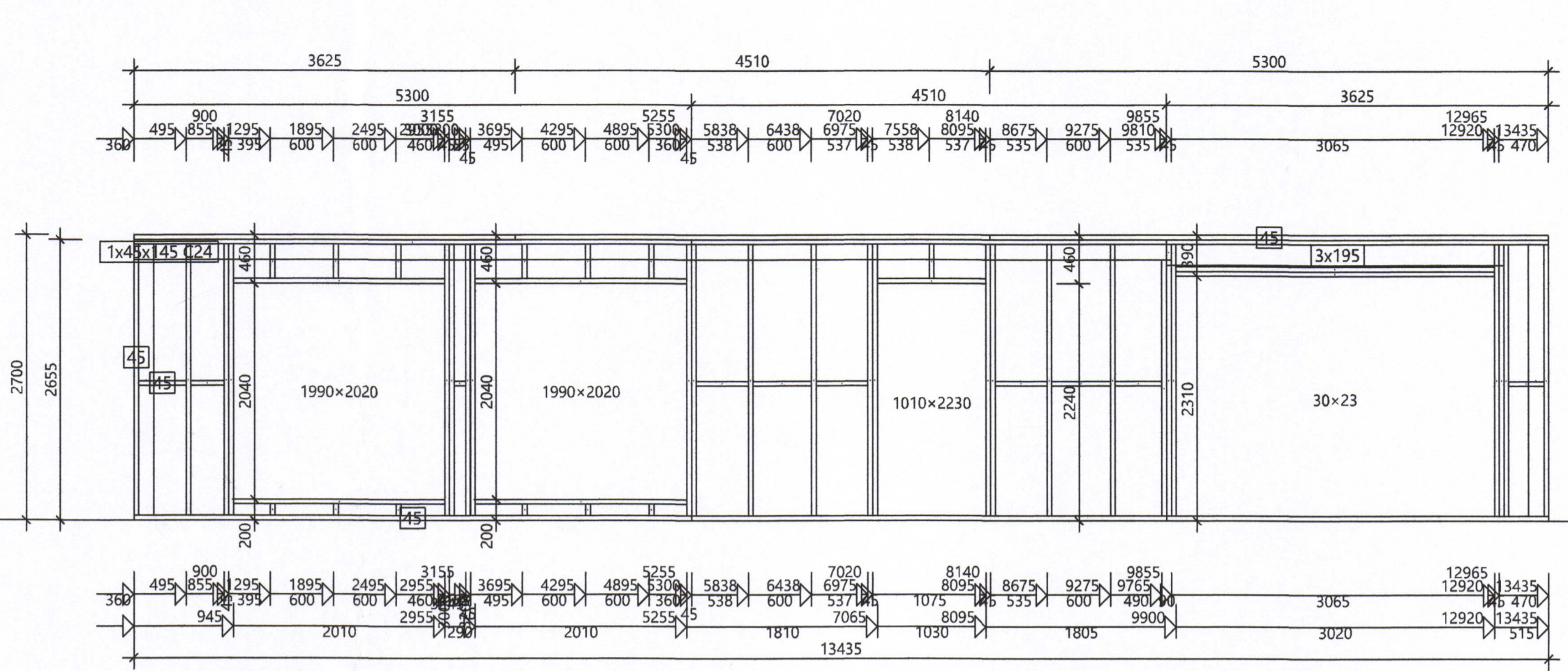

WP2 - 1 no. 1-ply 479 kg

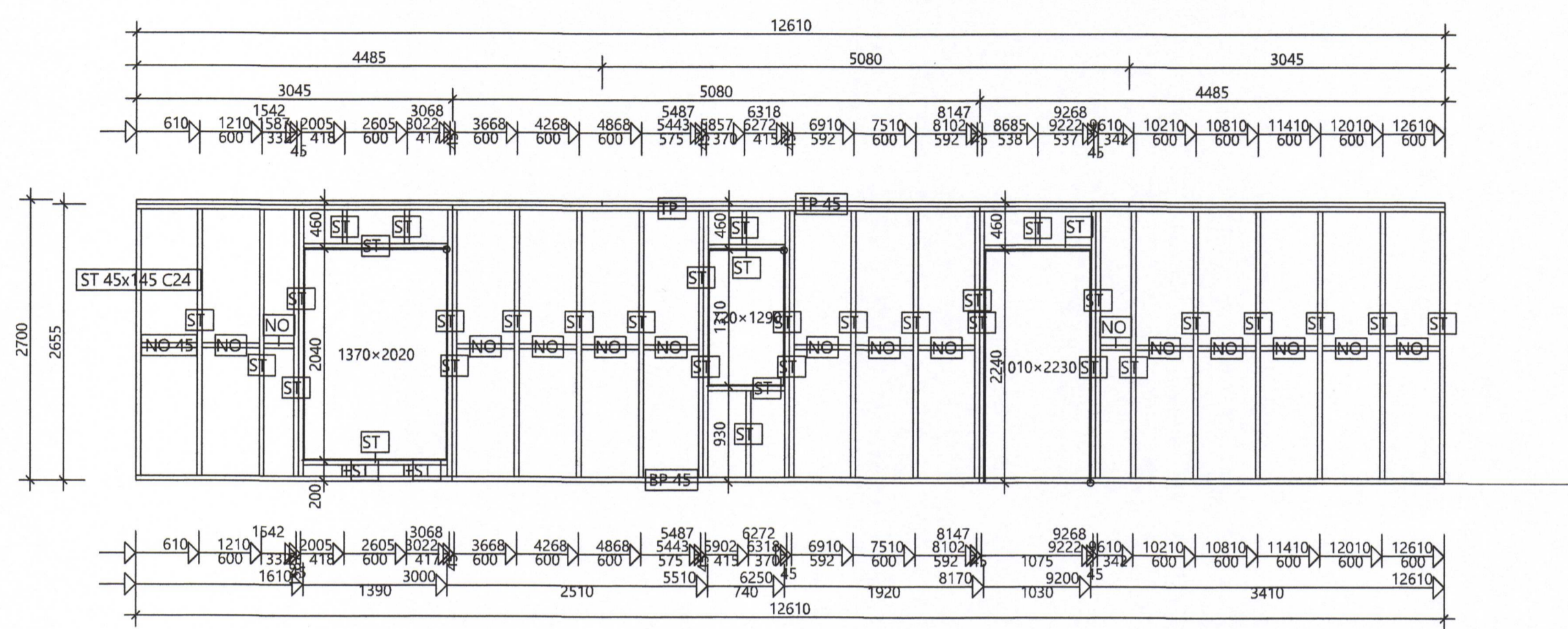

WP3 - 1 no. 1-ply 378 kg

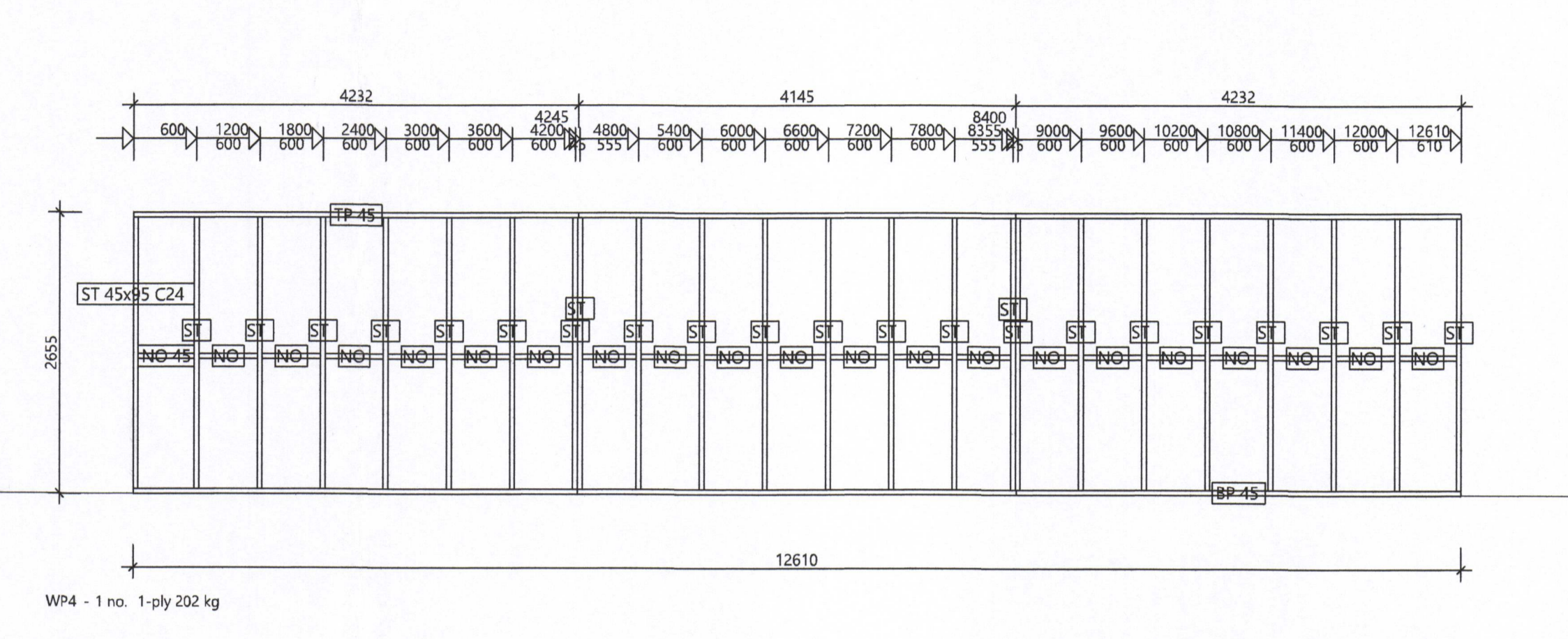

WP4 - 1 no. 1-ply 202 kg

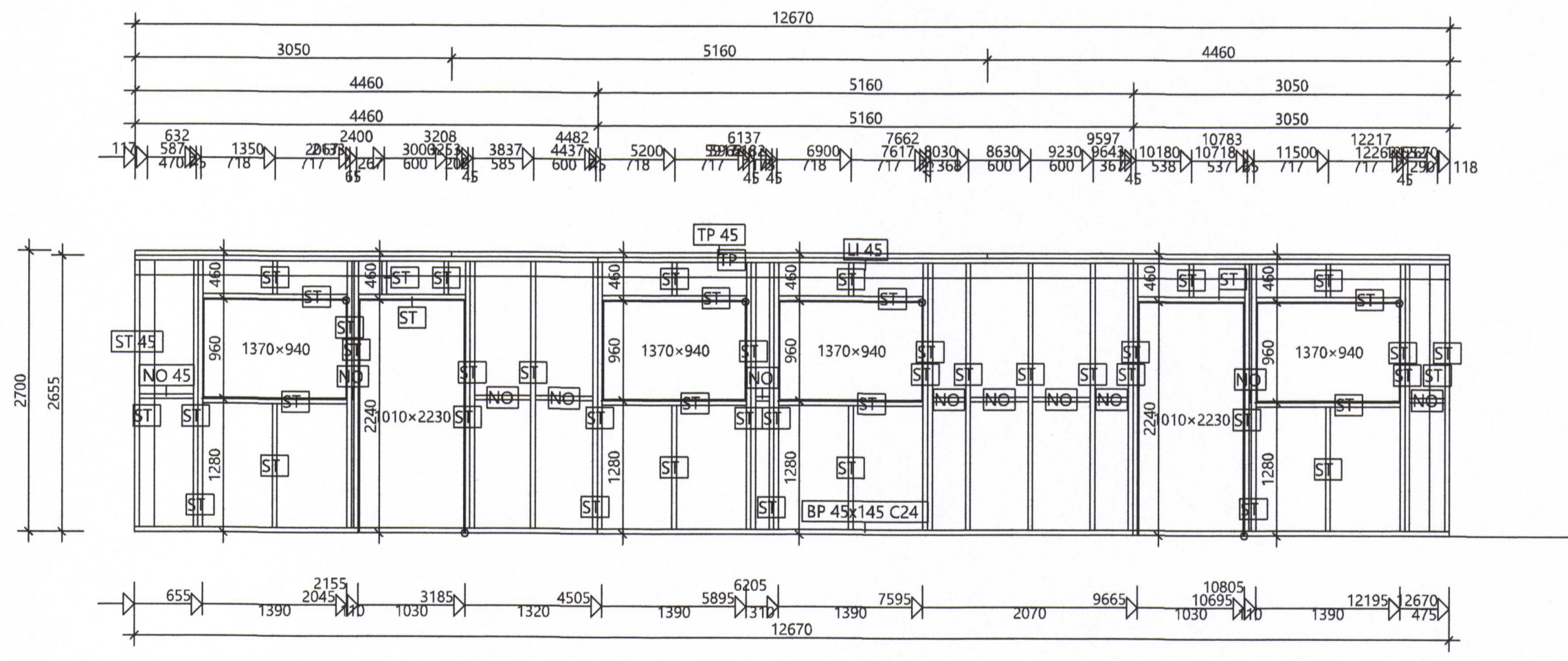

WP5 - 3 no. 1-ply 455 kg

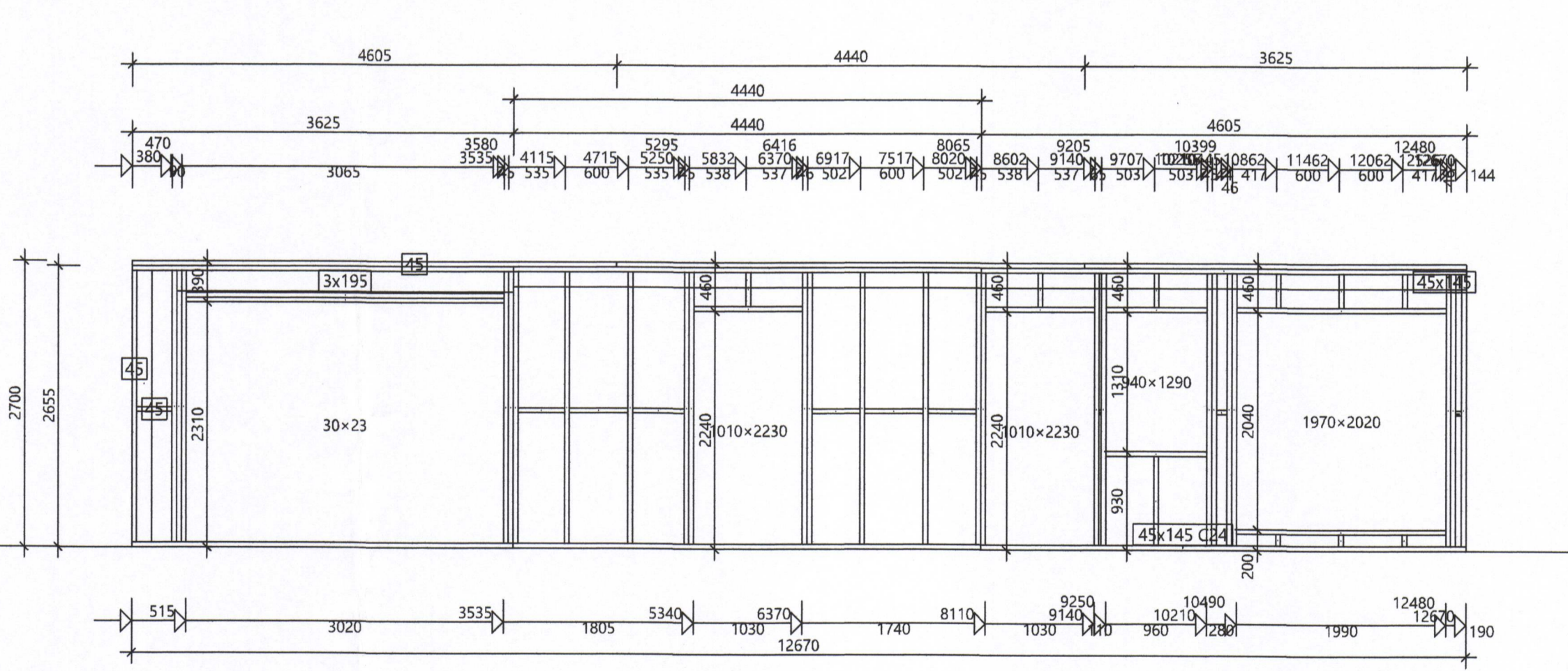

WP6 - 3 no. 1-ply 465 kg

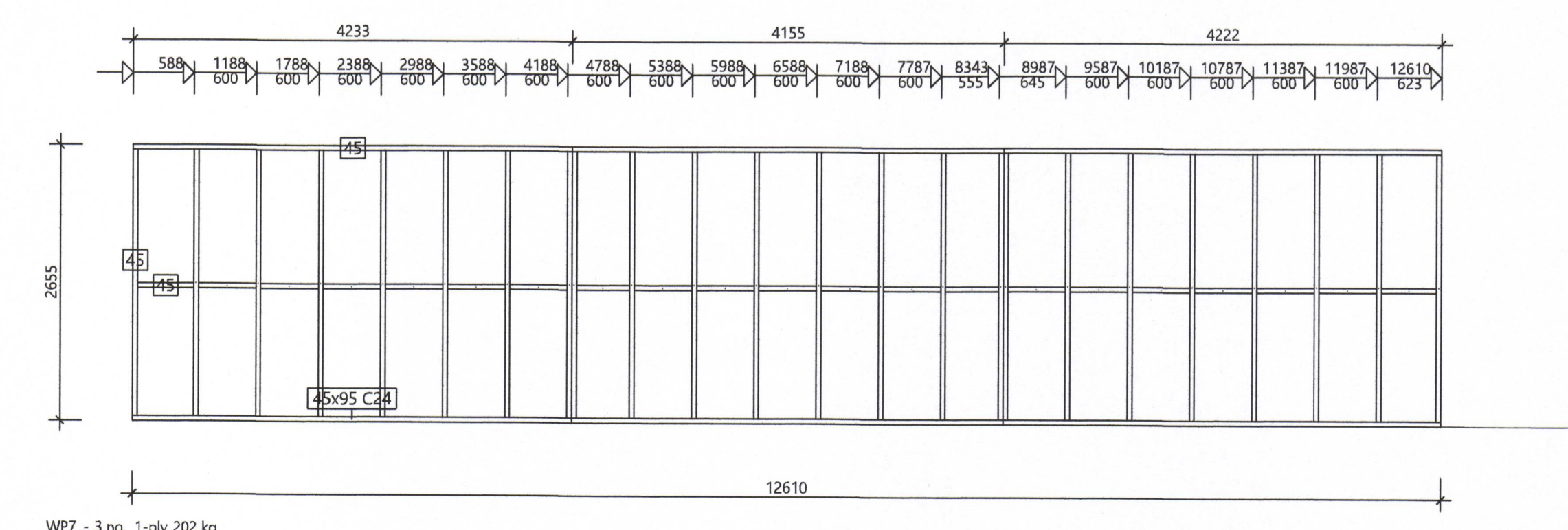

WP7 - 3 no. 1-ply 202 kg

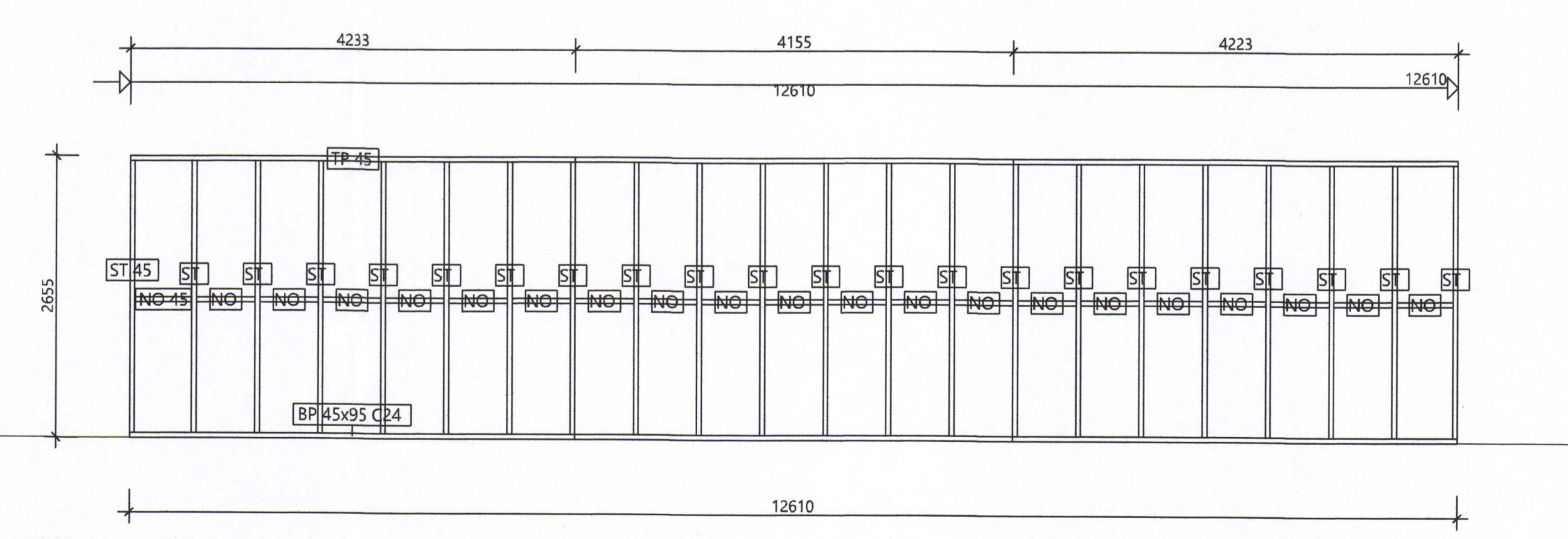

WP8 - 3 no. 1-ply 192 kg

C	TET
B	TET
A	TET
BR.Nr:	LÝSING:
AP:	DAGS:

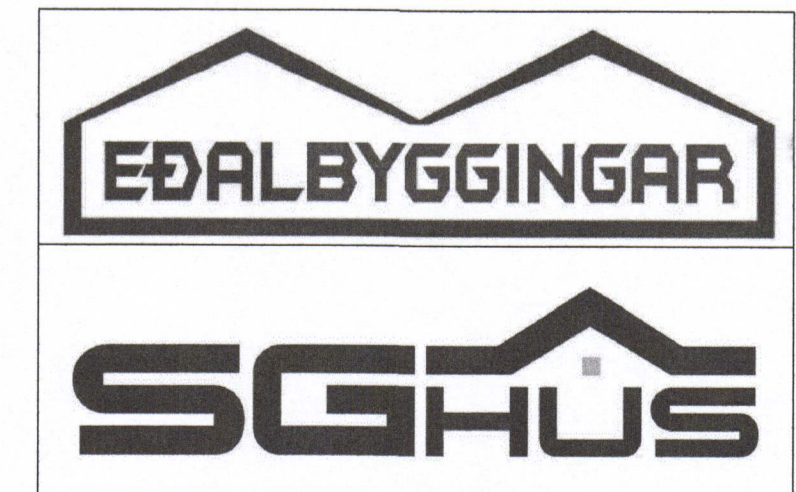

TÓMAS ELLERT TÓMASSON  
 BYGGINGARVERKFRÆÐINGUR M.S.C.E.  
 Sími: 853 8 358 - ellert@sghus.is

FOLDAURAUN 9-13

BURÐARVIRKI:	MEY:
VEGGIAGRINDUR	MEY: 1:50
HAMMAR: T.ELLERT	TEKNAÐ: T.ELLERT
VERNDÁMÉR: 19-09-2	SKRÁANNAFUR: 19-09-2-200-500-U1
DAÐSETNING: 28.05.2019	TEKNIÐINGUR: 212
201170-3979	