

1 stk aðalhurð

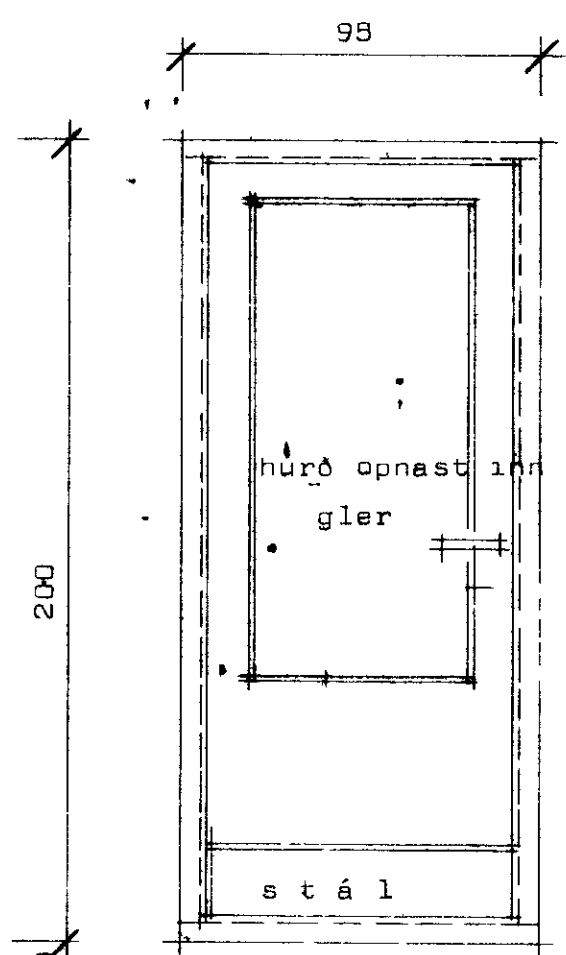

1 stk í kjallara

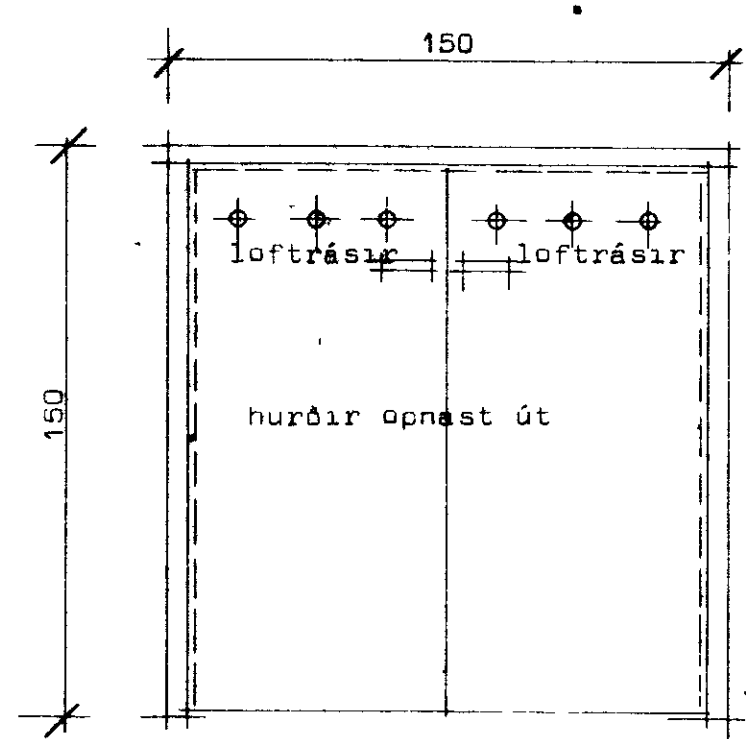

1 stk í sorpg.

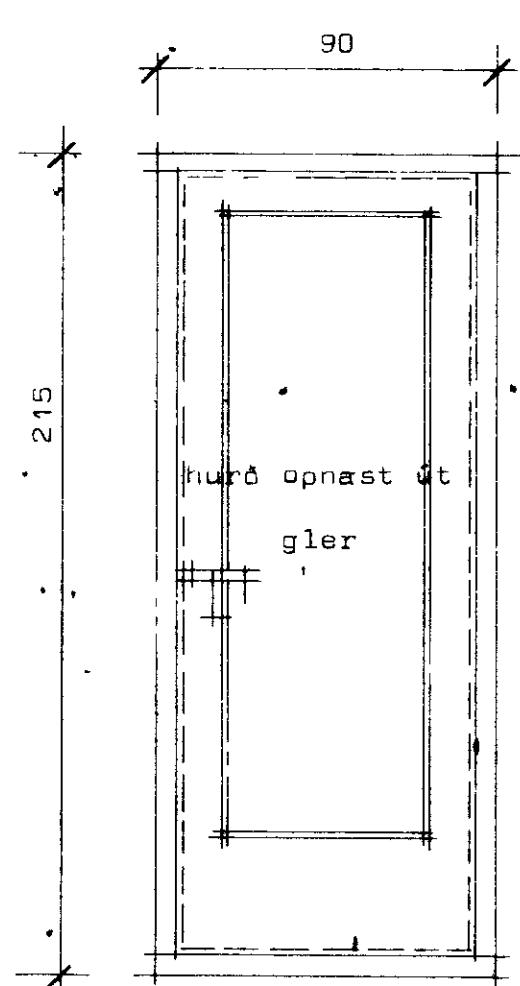

1 stk í stofu

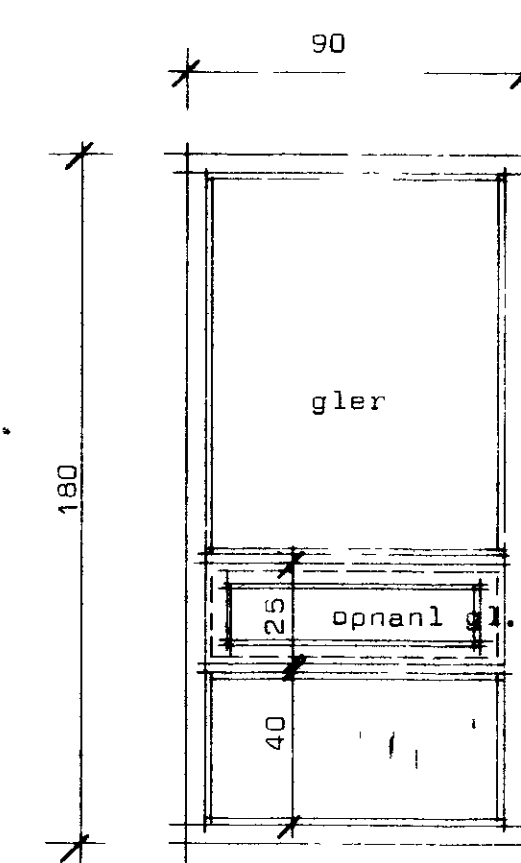

3 stk í stofu.

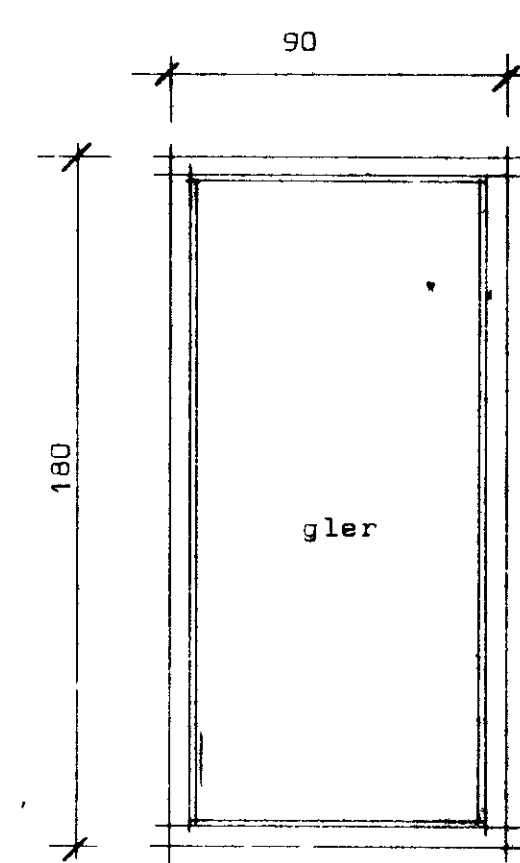

5 stk í stofu og stigi

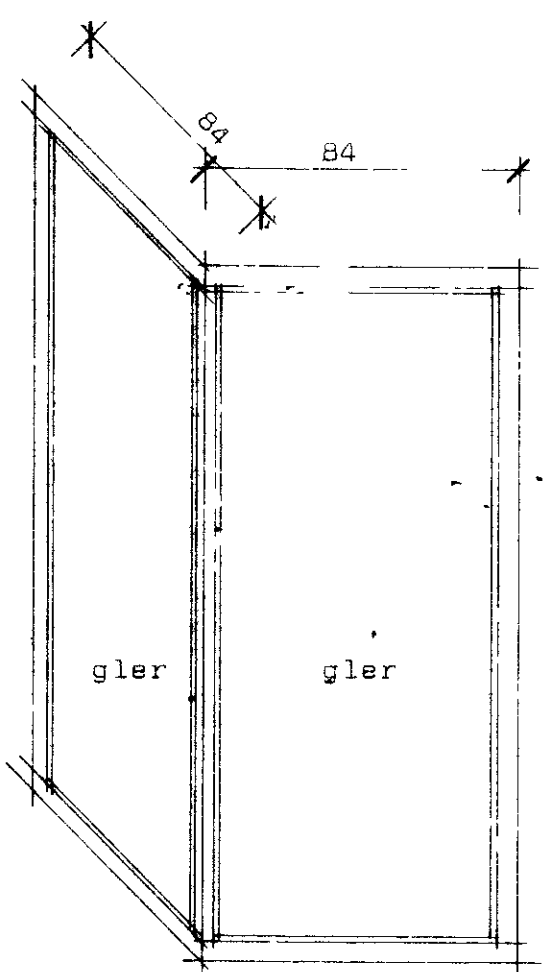

1 stk í stofu.

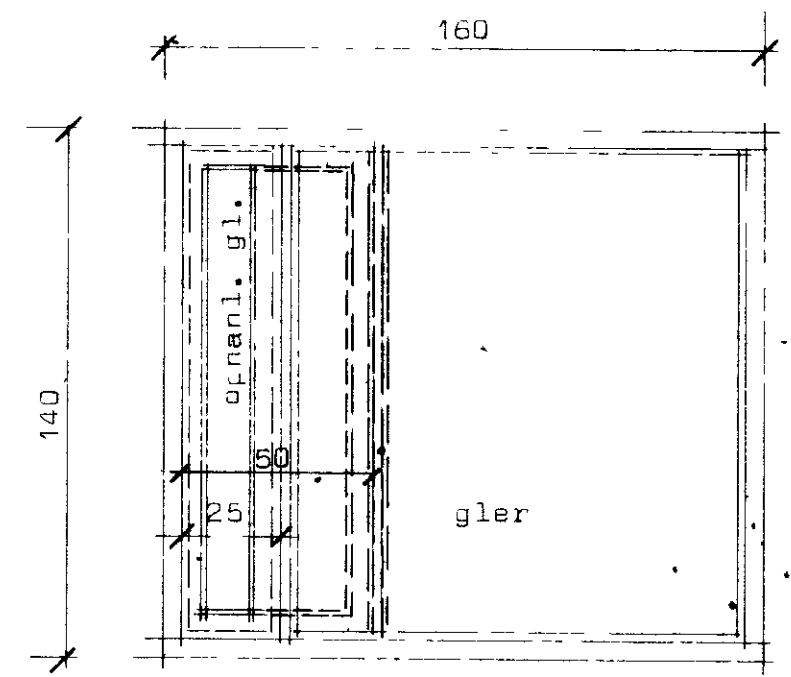

9 stk í herb, eldhús og kjallara  
þar af 2 með 50cm opnanl.

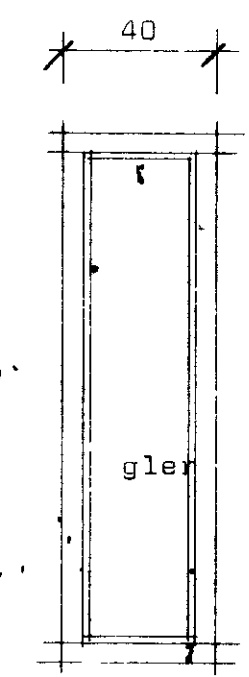

2 stk á bað þar  
af annar opnanl.

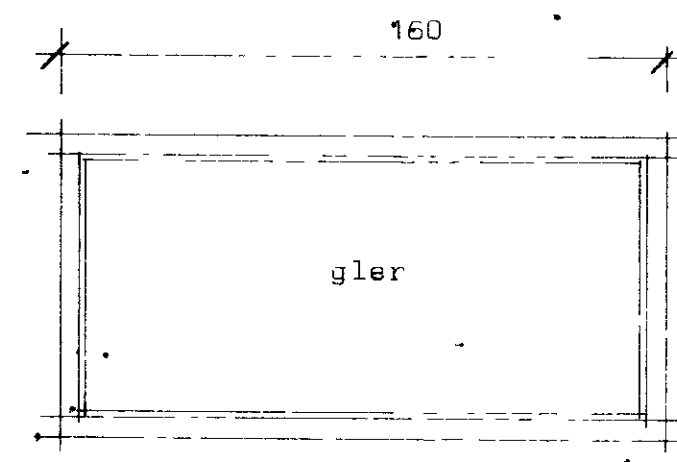

3 stk í kjallara

Ath. Mál af hurðum sem settar eru í á eftir takist á staðnum.

I gluggum sé valin fura eða oregonpine.  
Opnanlegir gluggar eru topphengdir.  
Gluggar séu úðavardir frá verkstæði.  
I aðalhurð sé harðviður t.d. teak.  
x merkir jörn bil innbyrðis í glugga.

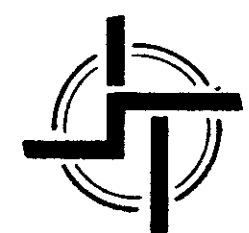

**STADALHÚS** T/S

TEIKNISTOFA Síðumúla 31 Sími 83141

VERKEFNI	DAGG.	1980	VERK NR
Hurðir og gluggar	MKV.	1:20	H4
	BR.		
	BLAD NR	1.06	

*Handwritten signatures and notes at the bottom of the page.*