

Snid A-A  
M:1:100

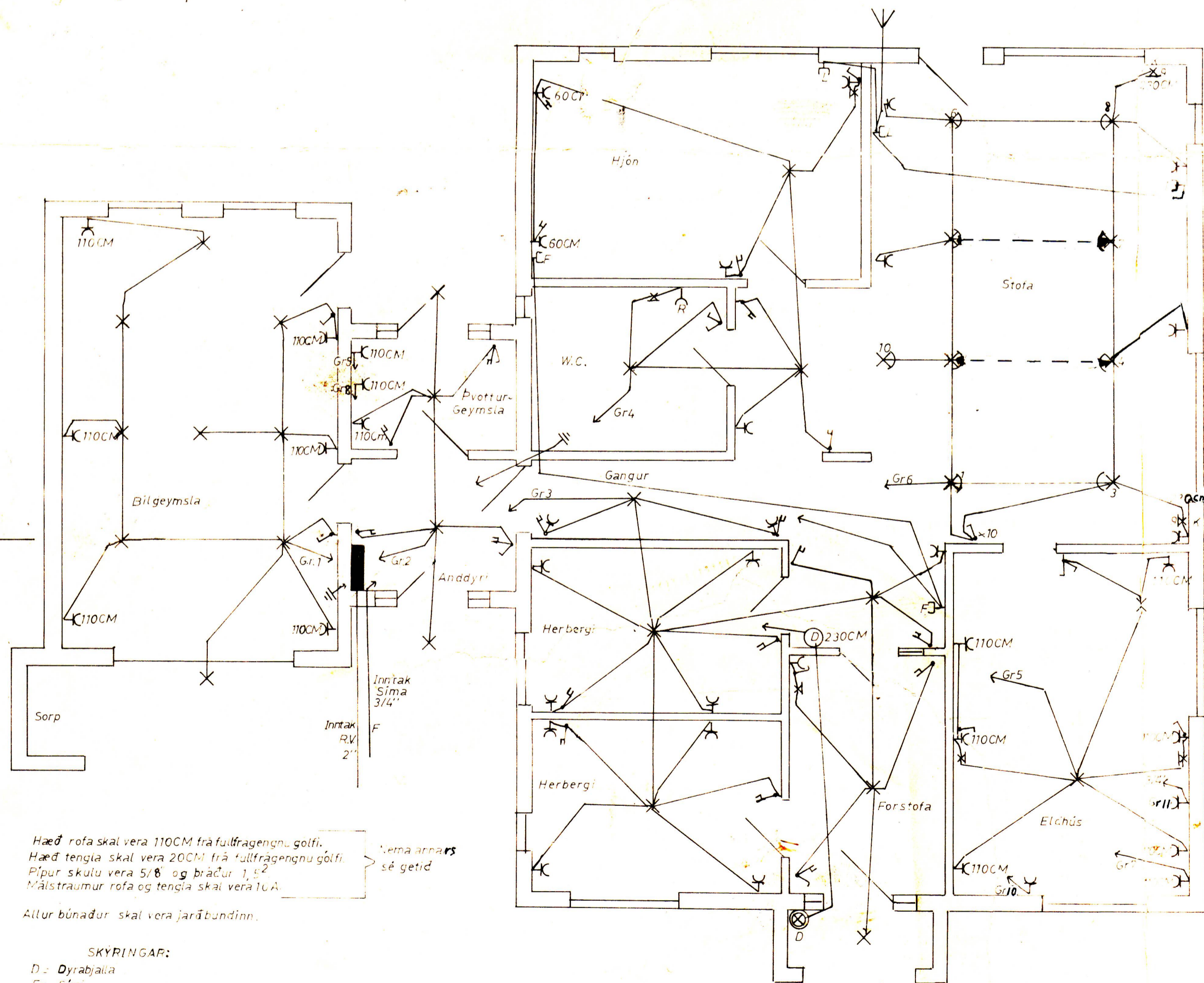

Tafla

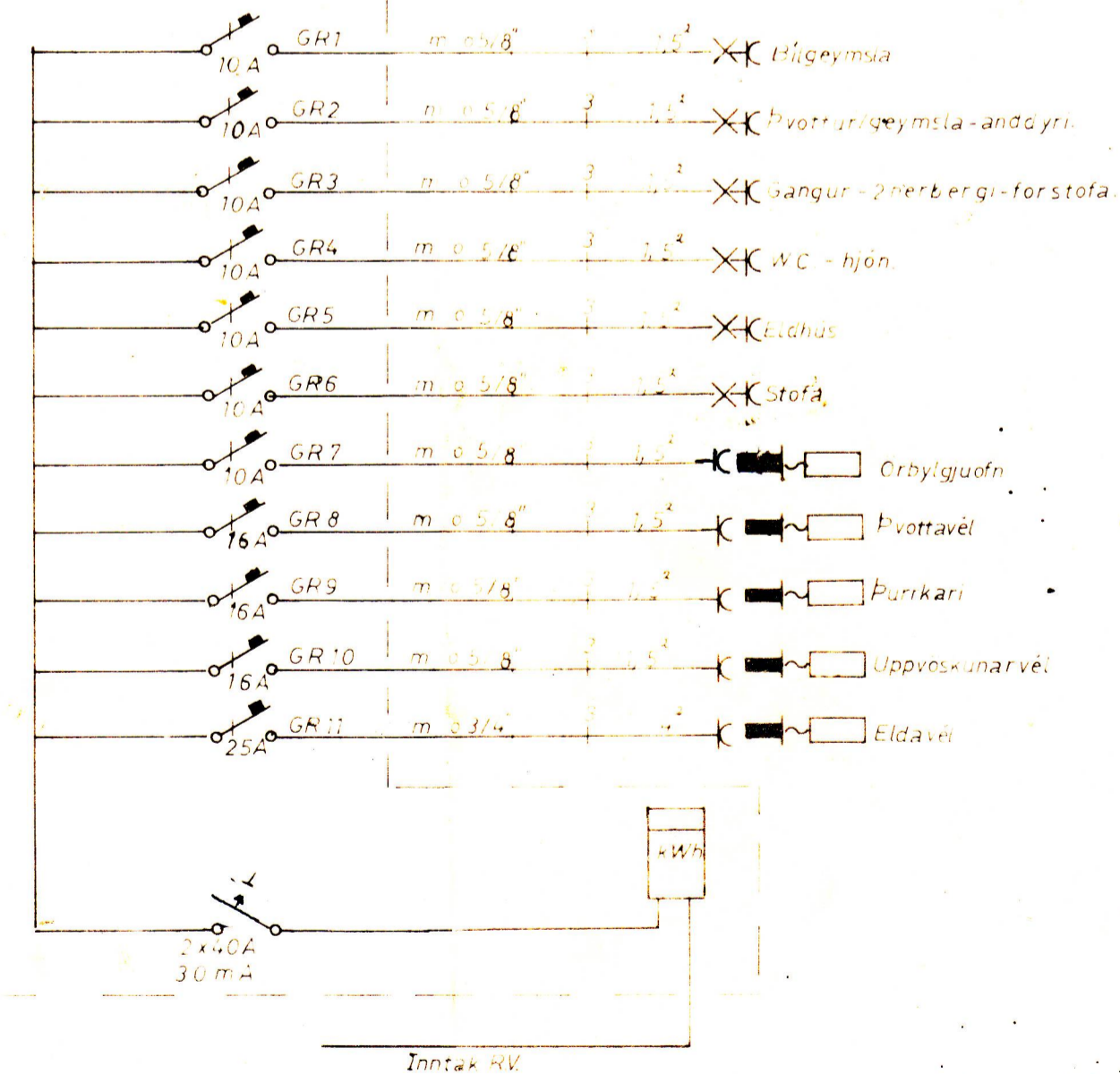

Hæð rofa skal vera 110CM frá fullfragengnu gólfi.  
Hæð tengia skal vera 20CM frá fullfragengnu gólfi.  
Pípur skulu vera 5/8" og bráður 1.5"  
Málstraumur rofa og tengia skal vera 10A.  
Eina annars sé getid

Allur búnaður skal vera jarðbundinn.

SKYRINGAR:

- D = Dyrabjalla
- F = Sími
- K = Kappólusing